

Rainscreen Cladding

Interlocking Plank System



eltherington
architectural solutions



Specification guide

www.eltherington.co.uk

IPS - Interlocking Plank System

About Eltherington Architectural Solutions

Eltherington architectural has been manufacturing façade systems for over 50 years.

All our rainscreen systems have been independently tested and accredited to the specific requirements of CWCT and come in an unrivalled choice of materials, colours and finishes to help you bring your design to life.

Our state of the art production facility allows us to take on board specialist architectural metal work projects of any scale. We fabricate a wide range of external architectural systems including rainscreen cladding, roofline products, column casings, perforated panels and any bespoke fabrication.

Specification

- Panel fire rating - A1 or A2
- Finish - PPC, Pre-paint, Corten, Rimex
- Thickness - 1 / 1.2 / 1.5mm
- Face Height - 150 to 350mm
- Face length - 6400mm max
- Horizontal joint - 10 - 20mm
- Vertical joint - Open, closed return or butt strap
- Fixings - Self drill mechanical fix
- Rail centres - 750mm
- Install method - Top > down
- CWCT tested horizontal & vertical fix

Typical Installation

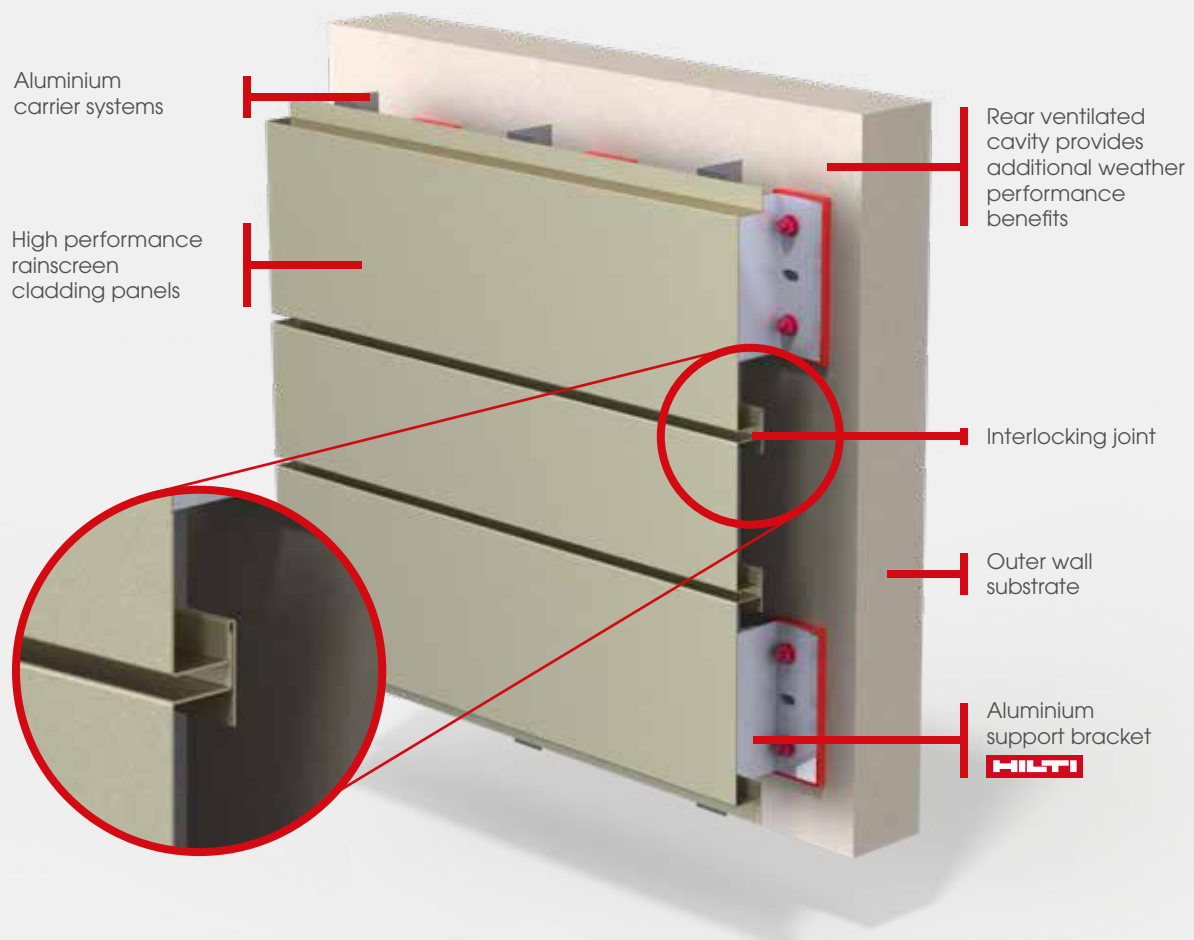

The Eltherington IPS is a pressed metal plank that is secretly fixed within the interlocking male and female joint. Available in a range of materials, finishes, face heights and lengths, this system can be fixed horizontally or vertically when installed on to our Hilti-Eurofox subframe.

The IPS is a top-down system which means the install starts at the top of the elevation, interlocking the top of one plank into the bottom of another.



Haggerston London

- 2mm aluminium
- Hilti subframe
- PPC finish
- 1500m²
- Architect - PRP Architects



Rainscreen Fire Ratings to EN13501-1

Definition	Product Name	Material	Manufacturer
A1 NON-COMBUSTIBLE	CoreClad A1	Aluminium	Eltherington
	Anodised	Aluminium	Eltherington
	Rimex various	Steel	Rimex
	Corten	Steel	Corten
	Alpolic A1	ACM	Alpolic
	PVDF	Aluminium	Arconic
A2	PPC	Aluminium	Eltherington
	Alucobond A2	ACM	Alucobond
	Alpolic A2	ACM	Alpolic

The Complete Rainscreen Solution by **HILTI** - Eltherington

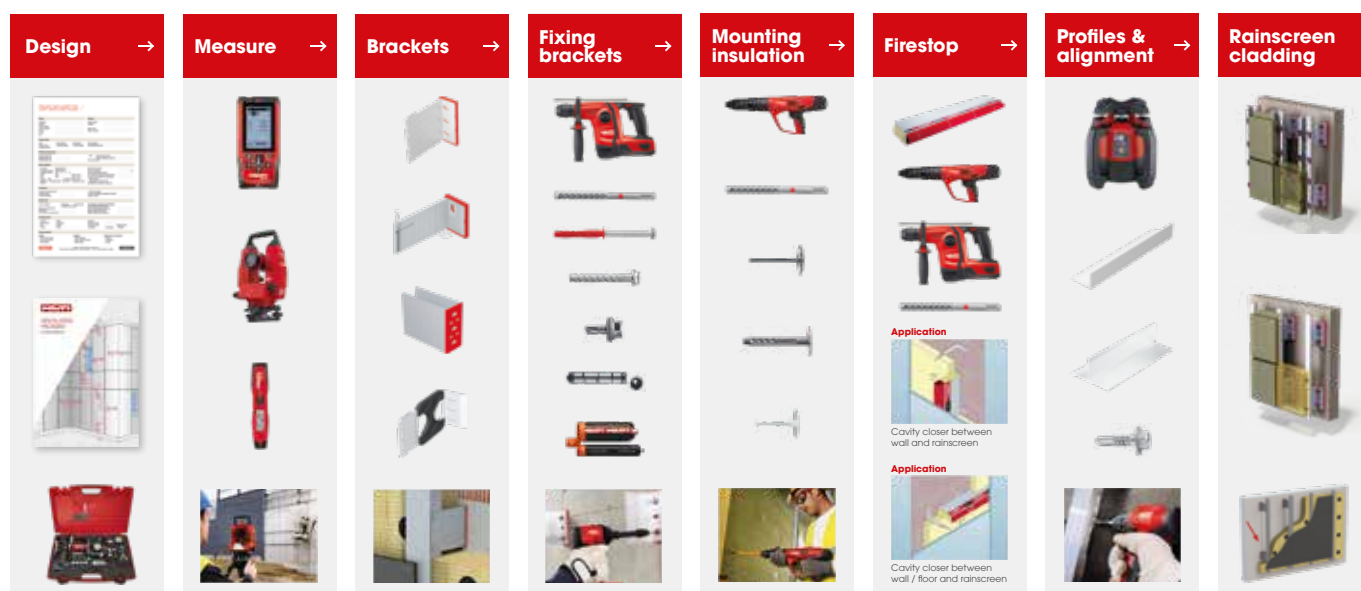

Other CWCT tested rainscreen cladding systems and designs:

TFS1 Through Fix System	EPS Extruded Plank System
SFS1 Secret Fix System	CS Castellation System
CPS Clip Plank System	P1 Perforated
IPS Interlocking Plank System	3D 3D Domed

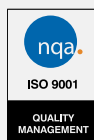

Contact Us

T: 01482 320336

F: 01482 329956

E: info@eltherington.co.uk

A: Eltherington Group Ltd,
1305 Hedon Road,
Hull, East Yorkshire, HU9 5QD

www.eltherington.co.uk



eltherington
architectural solutions