

# Rainscreen Cladding

## Clip Plank System



**eltherington**  
architectural solutions



**Specification guide**

[www.eltherington.co.uk](http://www.eltherington.co.uk)

# CPS - Clip Plank System

## About Eltherington Architectural Solutions

Eltherington architectural has been manufacturing façade systems for over 50 years.

All our rainscreen systems have been independently tested and accredited to the specific requirements of CWCT and come in an unrivalled choice of materials, colours and finishes to help you bring your design to life.

Our state of the art production facility allows us to take on board specialist architectural metal work projects of any scale. We fabricate a wide range of external architectural systems including rainscreen cladding, roofline products, column casings, perforated panels and any bespoke fabrication.

## Specification

- Panel fire rating - A1 or A2
- Finish - PPC, Pre-paint, Anodised Corten, Rimex
- Thickness: 1 / 1.2 / 1.5 / 2mm
- Face height - 150mm to 450mm
- Face length - 6400mm max
- Horizontal joint - 10mm to 20mm
- Vertical joint - Open, closed return or butt strap
- Clip fixings - Self drill mechanical fix
- Fixing centres - 750mm max
- Install method - Bottom > up
- CWCT tested horizontal & vertical fix

## Typical Installation

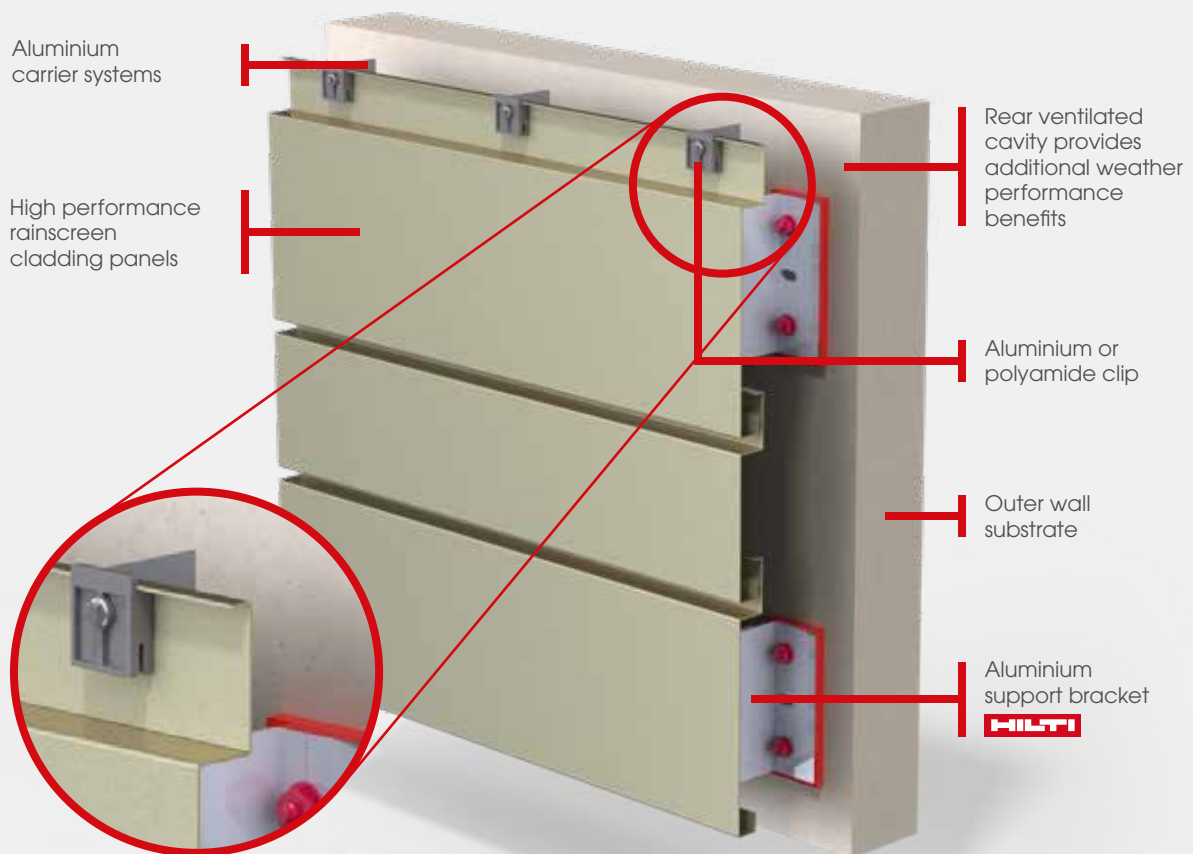

The Eltherington CPS is a folded metal plank that is secretly fixed on the plank returns with our polyamide clips. This engineered system allows for a larger plank face and joint detail resulting in a striking and bespoke linear design.

The CPS is a bottom to top system when installed horizontally, meaning the install starts at the bottom of the elevation and each plank locks in to the clip below.

Our horizontal and vertical Hilti-Eurofox subframe will accommodate the planks being installed in any orientation whilst applying the same clip fixing method.



## Jesmond 360

- 1.5mm aluminium
- Hilti subframe
- PPC finish
- 2000m<sup>2</sup>
- Architect - GT3 Architects



# Rainscreen Fire Ratings to EN13501-1

| Definition                | Product Name  | Material  | Manufacturer |
|---------------------------|---------------|-----------|--------------|
| <b>A1 NON-COMBUSTIBLE</b> | CoreClad A1   | Aluminium | Eltherington |
|                           | Anodised      | Aluminium | Eltherington |
|                           | Rimex various | Steel     | Rimex        |
|                           | Corten        | Steel     | Corten       |
|                           | Alpolic A1    | ACM       | Alpolic      |
|                           | PVDF          | Aluminium | Arconic      |
| <b>A2</b>                 | PPC           | Aluminium | Eltherington |
|                           | Alucobond A2  | ACM       | Alucobond    |
|                           | Alpolic A2    | ACM       | Alpolic      |

## The Complete Rainscreen Solution by **HILTI** - Eltherington

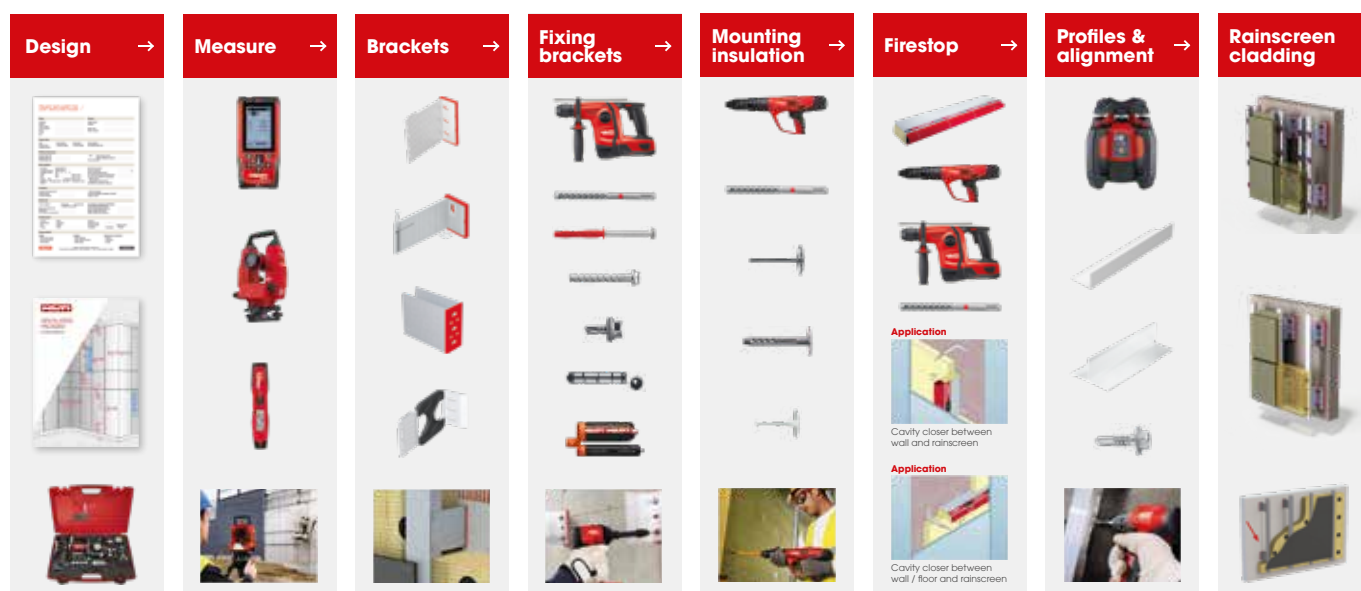

## Other CWCT tested rainscreen cladding systems and designs:

|                                      |                                  |
|--------------------------------------|----------------------------------|
| <b>TFS1</b> Through Fix System       | <b>EPS</b> Extruded Plank System |
| <b>SFS1</b> Secret Fix System        | <b>CS</b> Castellations System   |
| <b>CPS</b> Clip Plank System         | <b>P1</b> Perforated             |
| <b>IPS</b> Interlocking Plank System | <b>3D</b> 3D Domed               |

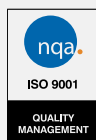

## Contact Us

**T:** 01482 320336

**F:** 01482 329956

**E:** [info@eltherington.co.uk](mailto:info@eltherington.co.uk)

**A:** Eltherington Group Ltd,  
1305 Hedon Road,  
Hull, East Yorkshire, HU9 5QD

[www.eltherington.co.uk](http://www.eltherington.co.uk)



**eltherington**  
architectural solutions