

Rainscreen Cladding Castellation System



eltherington
architectural solutions



Specification guide

www.eltherington.co.uk

C1 - Castellations

About Eltherington Architectural Solutions

Eltherington architectural has been manufacturing façade systems for over 50 years.

All our rainscreen systems have been independently tested and accredited to the specific requirements of CWCT and come in an unrivalled choice of materials, colours and finishes to help you bring your design to life.

Our state of the art production facility allows us to take on board specialist architectural metal work projects of any scale. We fabricate a wide range of external architectural systems including rainscreen cladding, roofline products, column casings, perforated panels and any bespoke fabrication.

Specification

- Finish - PPC, Pre-Paint, Anodised, Corten, Rimex
- Plank Lengths 6400mm max (dependant material availability) Horizontal Joint - Open or Butt strap
- Thickness - Max of 2mm
- Fixing - Self Drill mechanical fix
- Fixing centres - 300mm max
- Install method - Overlap right over left or vice versa
- CWCT tested with Hilti-Eurofox

Typical Installation

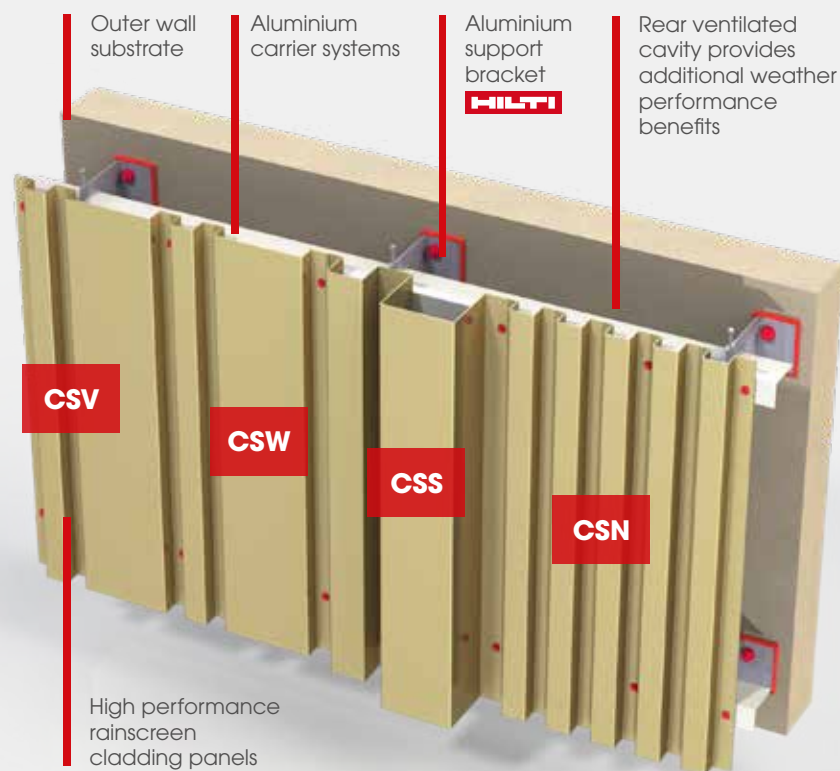

CSV



Castellation System Varied

CSW



Castellation System Wide

CSS



Castellation System Step

CSN



Castellation System Narrow

Cirlice Square, Manchester

- 2mm aluminium
- Bespoke subframe
- PPC finish
- 2500m²
- Architect - Feilden Clegg Bradley Studios



St Albans Leeds

- 2mm aluminium
- CSN and CSV systems
- PPC finish
- 400m²
- Architect - FCB Studios



Rainscreen Fire Ratings to EN13501-1

Definition	Product Name	Material	Manufacturer
A1 NON-COMBUSTIBLE	CoreClad A1	Aluminium	Eltherington
	Anodised	Aluminium	Eltherington
	Rimex various	Steel	Rimex
	Corten	Steel	Corten
	Alpolic A1	ACM	Alpolic
	PVDF	Aluminium	Arconic
A2	PPC	Aluminium	Eltherington
	Alucobond A2	ACM	Alucobond
	Alpolic A2	ACM	Alpolic

The Complete Rainscreen Solution by **HILTI** - Eltherington

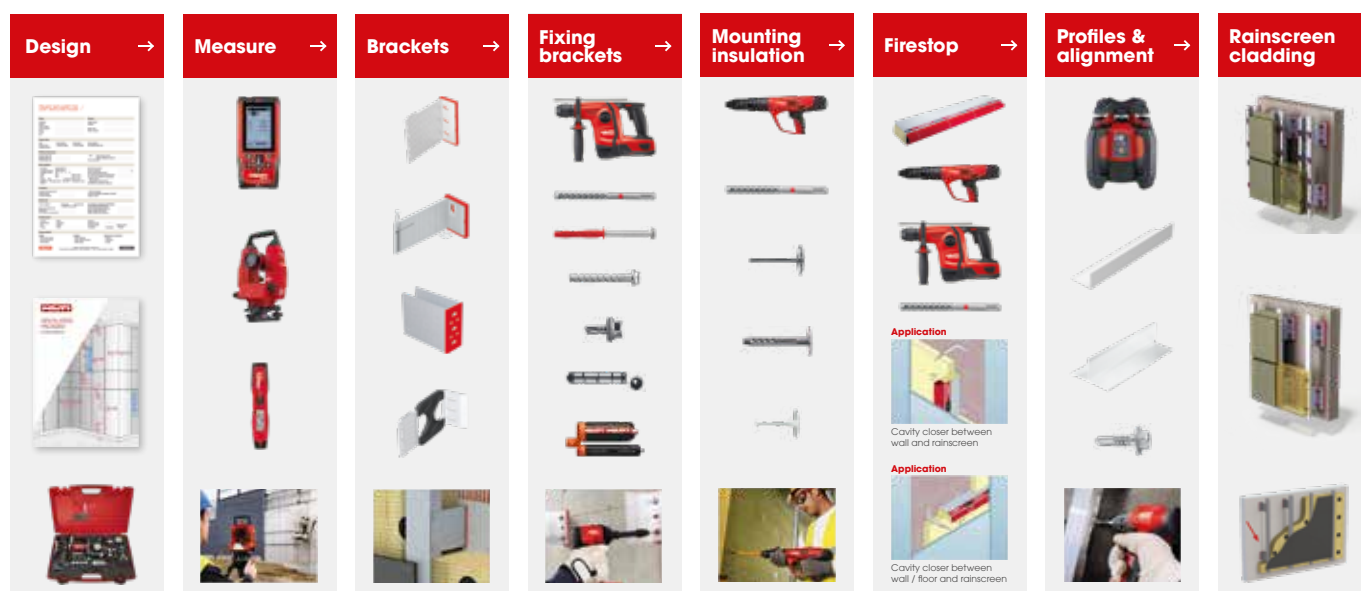

Alternative design options by Eltherington Architectural:

CS Castellation System



3D 3D Domed

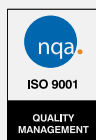

Contact Us

T: 01482 320336

F: 01482 329956

E: info@eltherington.co.uk

A: Eltherington Group Ltd,
1305 Hedon Road,
Hull, East Yorkshire, HU9 5QD

www.eltherington.co.uk



eltherington
architectural solutions