

# Rainscreen Cladding

## Geometric Plank System



**eltherington**  
architectural solutions



**Specification guide**

[www.eltherington.co.uk](http://www.eltherington.co.uk)

# GPS - Geometric Plank System

## About Eltherington Architectural Solutions

Eltherington architectural has been manufacturing façade systems for over 60 years.

All our rainscreen systems have been independently tested and accredited to the specific requirements of CWCT and come in an unrivalled choice of materials, colours and finishes to help you bring your design to life.

Our state of the art production facility allows us to take on a broad range of specialist architectural metal work projects of any scale. We fabricate a wide range of external architectural systems including rainscreen cladding, roofline products, column casings, perforated panels and any bespoke fabrication.

## Specification

- Panel fire rating - A1 or A2I
- Finish - PPC, Pre-paint, Anodised Corten, Rimex
- Thickness: 1 / 1.2 / 1.5 / 2mm
- Face height - 125 - 450mm
- Face length - 6000mm max
- Horizontal joint - 10 - 20mm
- Vertical joint - Open
- Clip fixings - Self drill mechanical fix
- Fixing centres - 750mm max
- Install method - Bottom > up
- CWCT tested with Hilti-Eurofox

## Typical Installation

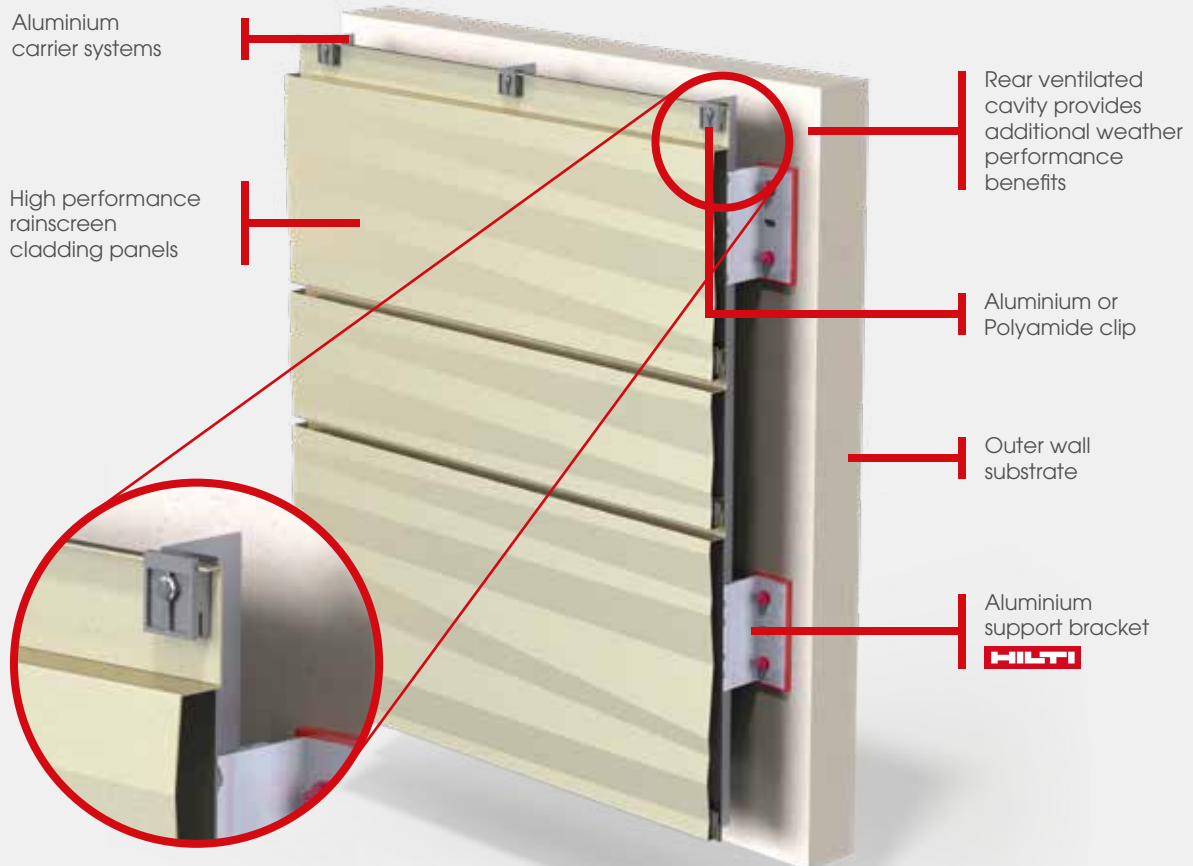

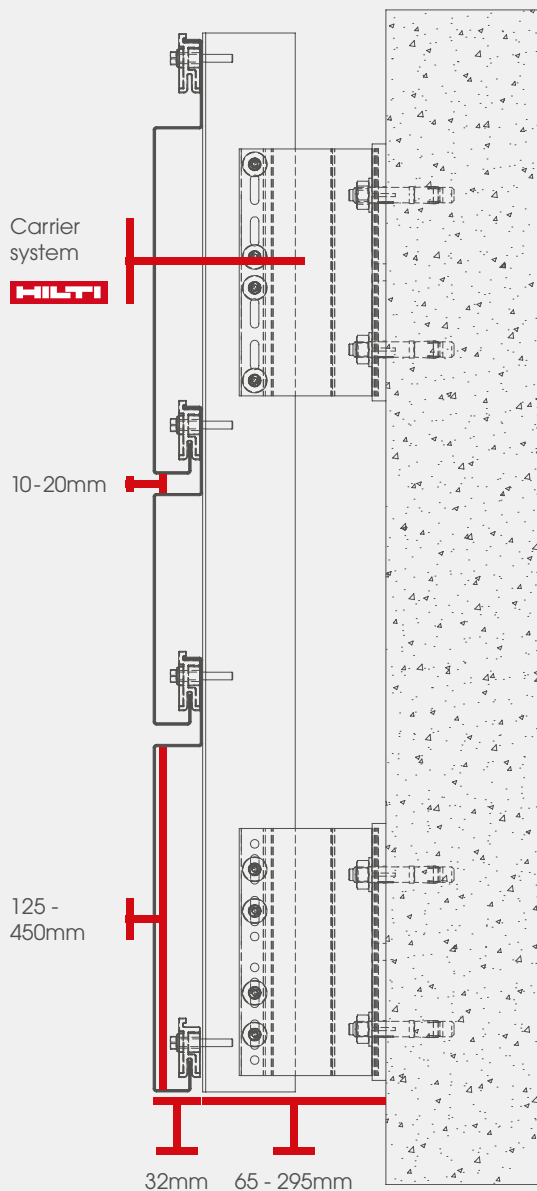

The Eltherington GPS is a folded geometric faced metal plank that is secretly fixed on the plank returns with our aluminium or polyamide clips. This engineered system allows for a larger plank face and joint detail resulting in a striking and bespoke linear design.

The GPS is a bottom to top system when installed horizontally, meaning the install starts at the bottom of the elevation and each plank locks in to the clip below.

Our horizontal and vertical Hilti-Eurofox subframe will accommodate the planks being installed in any orientation whilst applying the same clip fixing method.





# Rainscreen Fire Ratings to EN13501-1

Definition	Product Name	Material	Manufacturer
<b>A1 NON-COMBUSTIBLE</b>	CoreClad A1	Aluminium	Eltherington
	Anodised	Aluminium	Eltherington
	Rimex various	Steel	Rimex
	Corten	Steel	Corten
	Alpolic A1	ACM	Alpolic
	PVDF	Aluminium	Arconic
<b>A2</b>	PPC	Aluminium	Eltherington
	Alucobond A2	ACM	Alucobond
	Alpolic A2	ACM	Alpolic

## The Complete Rainscreen Solution by **HILTI** - Eltherington

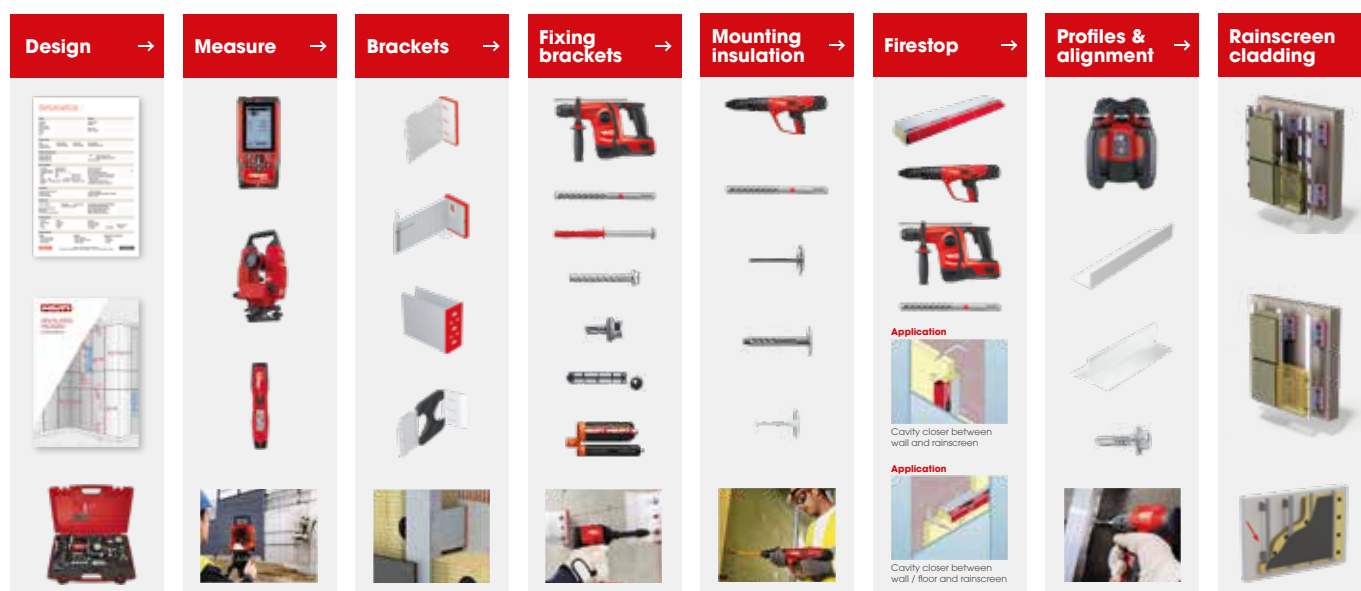

## Other CWCT tested rainscreen cladding systems and designs:

<b>TFS1</b> Through Fix System	<b>EPS</b> Extruded Plank System
<b>SFS1</b> Secret Fix System	<b>CS</b> Castellated System
<b>CPS</b> Clip Plank System	<b>P1</b> Perforated
<b>IPS</b> Interlocking Plank System	<b>3D</b> 3D Domed



## Contact Us

**T:** 01482 320336

**F:** 01482 329956

**E:** [info@eltherington.co.uk](mailto:info@eltherington.co.uk)

**A:** Eltherington Group Ltd,  
1305 Hedon Road,  
Hull, East Yorkshire, HU9 5QD

[www.eltherington.co.uk](http://www.eltherington.co.uk)



**eltherington**  
architectural solutions